

SIDE LOCKER ASSEMBLY INSTRUCTIONS

Tool Vault TV-7203SL

REQUIRED TOOLS:

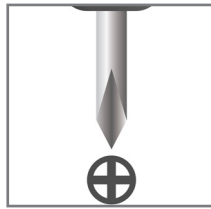

PHILLIPS-HEAD
SCREWDRIVER



10MM
WRENCH

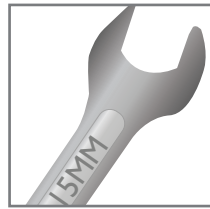

15MM
WRENCH

1. OPEN CARTON, REMOVE FROM PALLET

Cut all straps with the BOX CUTTER, then lift the cardboard packaging off the side locker. Remove side locker from pallet.

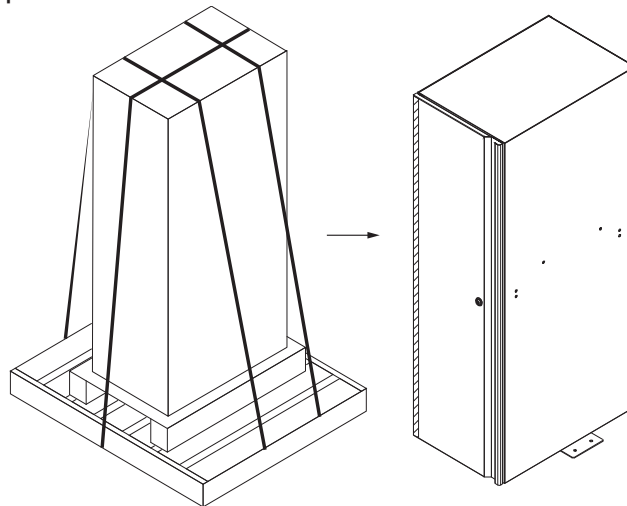

2. (OPTIONAL) REVERSE HANGER IF INSTALLING RIGHT SIDE LOCKER

By default, the door and hanger are configured as a left side locker. If you are installing the side locker to the right side of the toolbox, you will need to reverse the hanger, then later reverse the door towards the end of this guide. First you will need to remove the hanger from the right panel, unfasten each bolt with washer. Use the existing **WASHERS** and **M6x12 HEX BOLTS** to fasten the **HANGER** to the left side locker panel that faces the right side of the tool box.

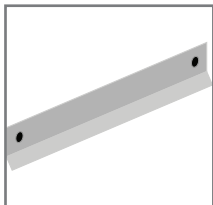

HANGER

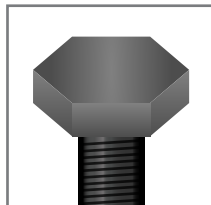

M6X12
HEX BOLT

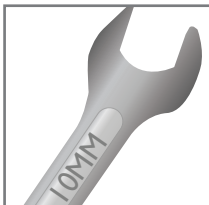

10MM
WRENCH

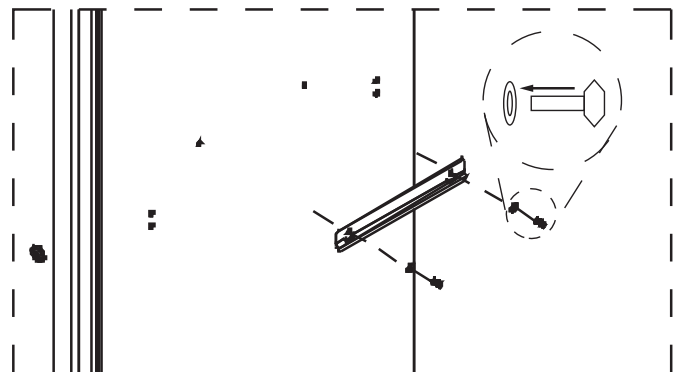

3. INSTALL THE EVA LINER, REMOVE SHELVES AND DRAWERS

Place both **LINERS** on the side with the hanger, near the bottom of the side locker.

Remove all shelves and drawers from inside of the side locker to prepare for a later step.

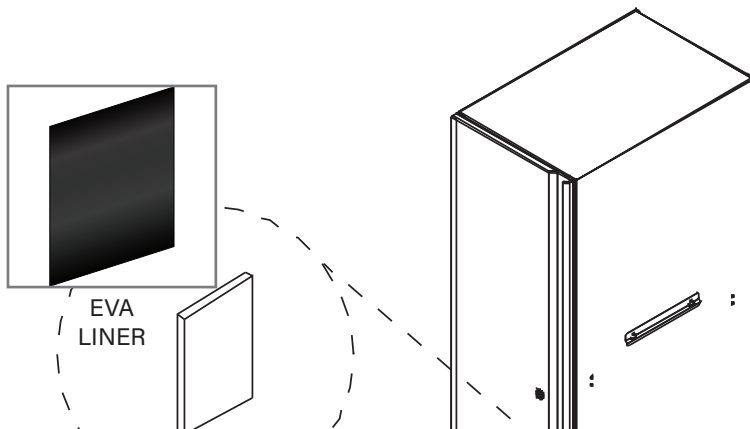

PUSH UP
(ONE HAND SIDE LEVER)

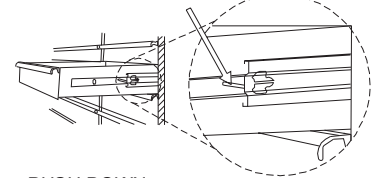

PUSH DOWN
(THE OTHER HAND SIDE LEVER)

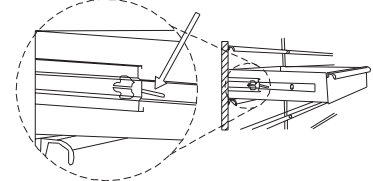

4. (OPTIONAL) INSTALL SPRING LOADED CASTERS

If part of your order, you will need to install the spring loaded casters, which allow you to load the side locker beyond 250 lbs.

Lay the side locker flat on a soft mat, position the two **SPRING LOADED CASTERS** on the bottom of the locker, outer side. Insert the included **HEX BOLTS** through **WASHERS**, then through the **CASTERS**. Tighten securely to the weld nuts.



SPRING
LOADED
CASTER

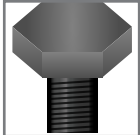

HEX BOLT
(FOR CASTER)

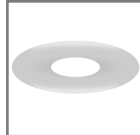

WASHER



15MM
WRENCH

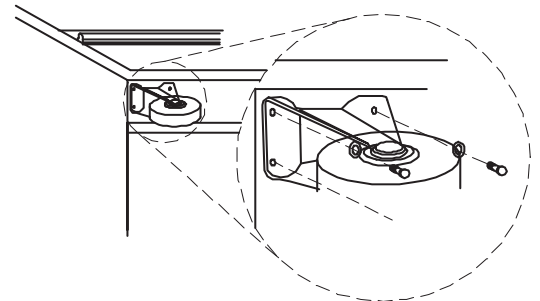

5. HANG SIDE LOCKER

Hang the side locker off the top edge of the roller cabinet.

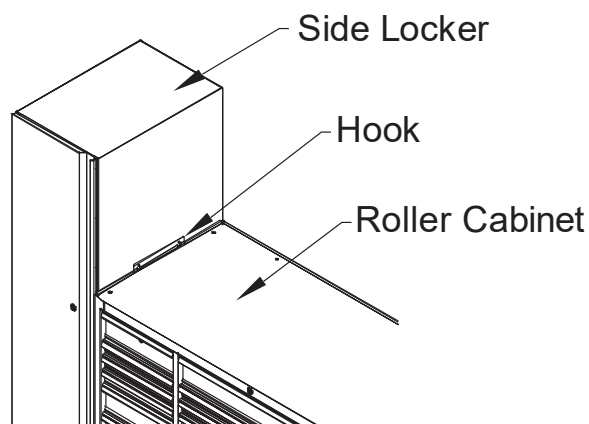

6. FASTEN SIDE LOCKER TO TOOL BOX

Open the door of the side locker. Inside, find the 4 bolt holes that connect to the weld nuts on the roller cabinet.

Thread each **M6x20 BOLT** through a **SPRING WASHER**, then a **WASHER**. Fasten each washer equipped bolt to the 4 weld nuts.

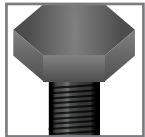

M6X20
HEX BOLT



SPRING
WASHER

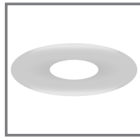

WASHER



10MM
WRENCH

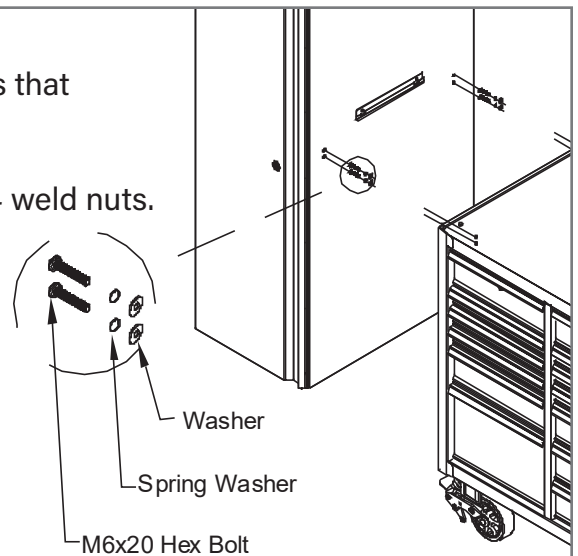

7. INSTALL CONNECTION CHANNEL

Underneath the tool box, locate the weld nuts that will fasten the bottom of the side locker to the roller cabinet using the connection channel. Thread 4 **M6x20 HEX BOLTS** into each of the weld nuts, fasten with a **xxMM WRENCH**. You may now replace all shelves and drawers.

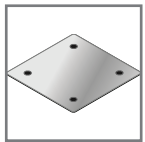

CONNECTION
CHANNEL

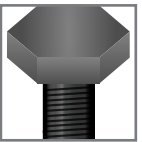

M6X20
HEX BOLT



10MM
WRENCH

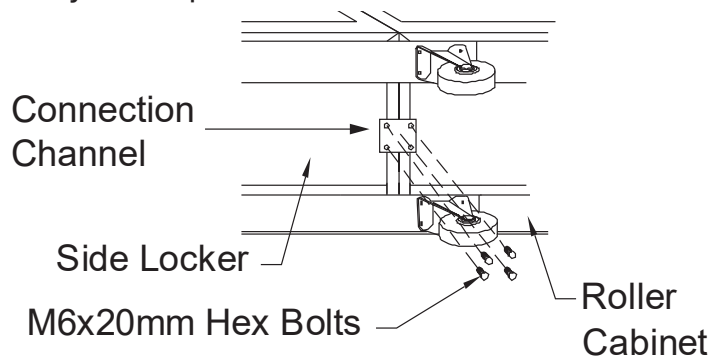

8. (RIGHT SIDE LOCKER) REMOVE DOOR TO REVERSE

If you have installed the side locker to the right side of the roller cabinet, you will need to reverse the door. Remove all **M4x12 COUNTERSUNK SCREWS** from the left door hinge, set aside, remove the door. Remove each magnet from the right frame then insert into each slot on the left frame.

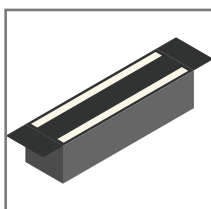

DOOR
MAGNET

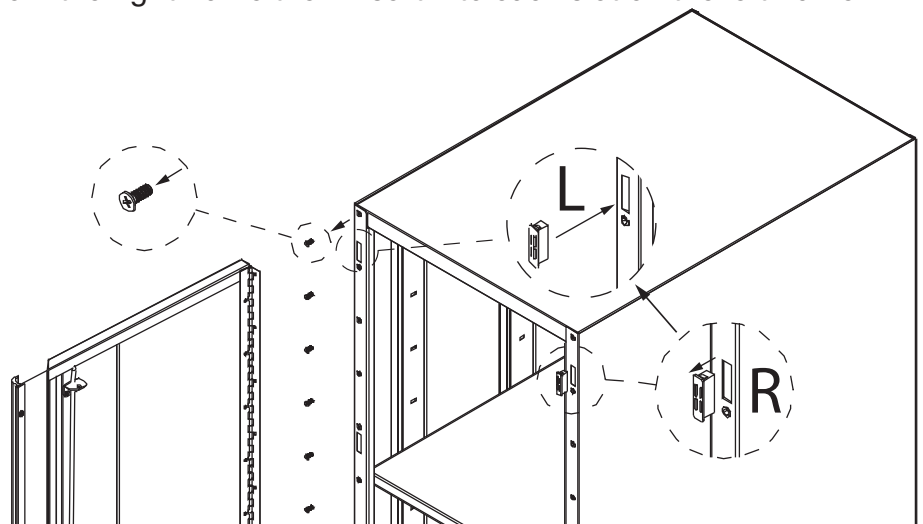

9. (RIGHT SIDE LOCKER) REVERSE LOCK BAR AND FLIP DOOR

Remove the 4 screws that fasten the lock bar to the door.

Turn the lock bar upside down so the long side is on the top and the short side is on the bottom.

Fasten lock bar in place with the existing screws.

Flip the door upside down, then fasten the hinge to the right side of the frame with the existing

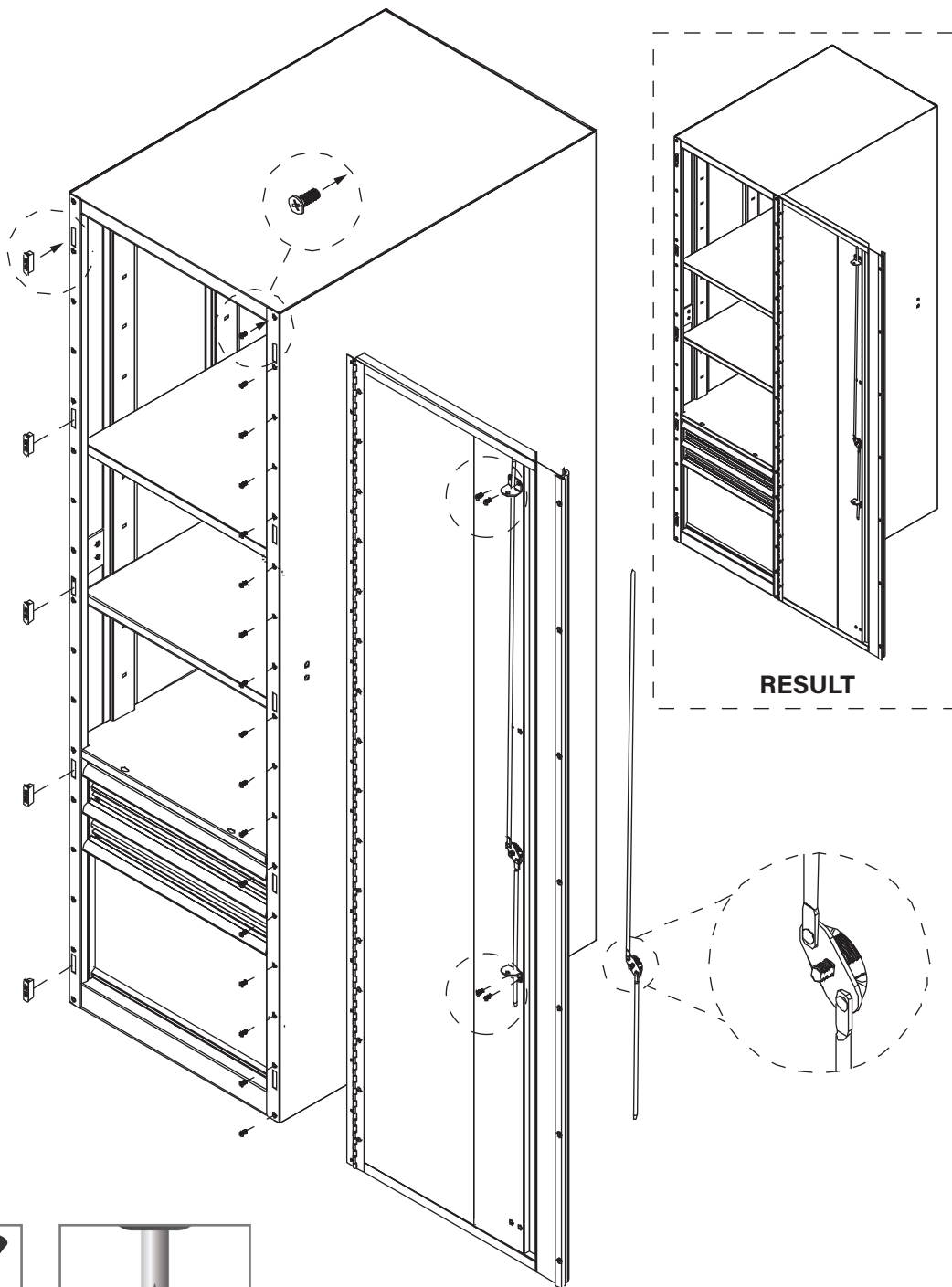

M4X12
COUNTERSUNK
SCREW

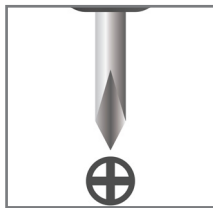

PHILLIPS-HEAD
SCREWDRIVER

HARDWARE LIST

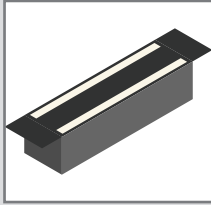

#1
5 pcs.

DOOR
MAGNET



#2
21 pcS.

M4X12
COUNTERSUNK SCREW



#3
12 pcs.

SHELF
SUPPORT

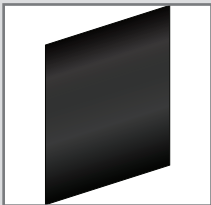

#4
2 pcs.

EVA
LINER

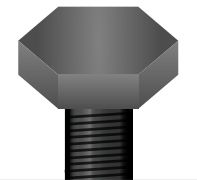

#6, 10
8 pcs.

M6X20
HEX BOLT



#7
10 pcs.

WASHER

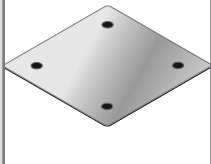

#8
1 pcs.

CONNECTION
CHANNEL



#9
8 pcs.

SPRING WASHER

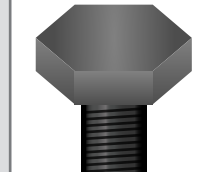

#11
4 pcs.

M6X12
HEX BOLT

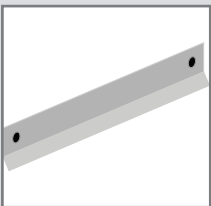

#12
1 pc.

HANGER

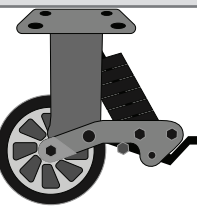

OPTIONAL
2 pcs.

SPRING
LOADED CASTER

OVERVIEW

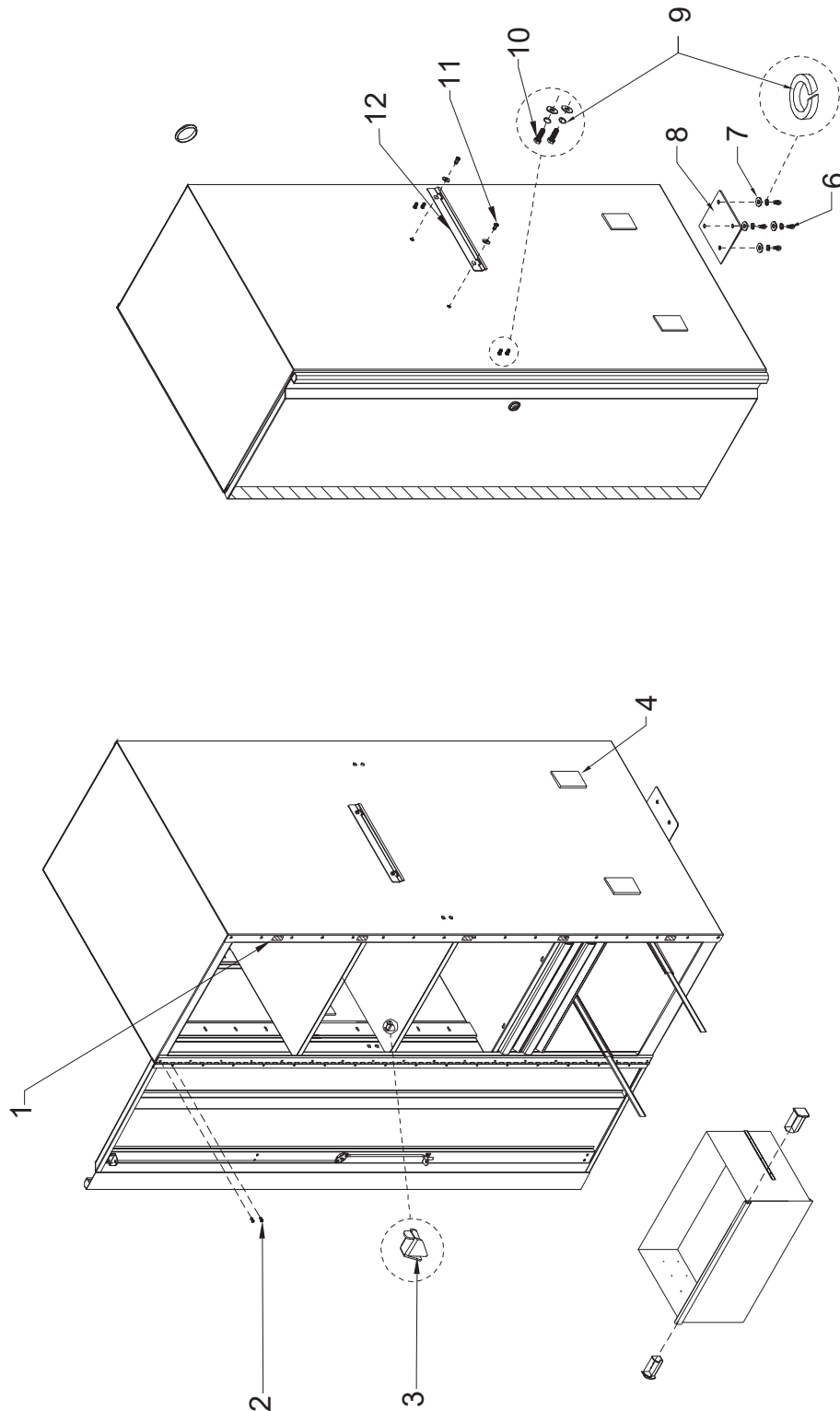

STRICTLYTOOLBOXES.com

888-289-1952

DIRECT LINE: 352.672.6566
FAX: 352.226.8579
EMAIL: sales@strictlytoolboxes.com

HOURS:
MON-THU 9:00am - 6:00pm EST.
FRI 9:00am - 5:00pm EST.

ADDRESS:
Strictly Tool Boxes
4820 NE 49th Ave
Gainesville, FL 32609